

Historic school is the primary focus in new Craigmillar plans

Victorian building to be centrepiece of latest development

GARETH EDWARDS

A VICTORIAN school building is set to be restored to its former glory as part of the multi-million-pound regeneration of Craigmillar.

The former Niddrie Mill Primary School – one of the most striking buildings in the area – will become the centrepiece of a development of more than 50 homes.

Although many of the existing classrooms are to be demolished, the historic main school building is to be restored and returned to its original shape, without its more modern wings.

The interior will be converted into around 12 private flats.

A mixture of detached and semi-detached houses, townhouses and blocks of three and four-storey flats are to be built around it.

The plans are the latest phase of the £200 million, 15-year plan to regenerate Craigmillar, which will eventually see more than 3000 new homes built, with 150 acres of surrounding open space turned into a “green quarter” with parks, river walkways, woodland and play areas.

The first stage of the project was completed earlier this year, with the opening of a multi-million-pound campus bringing together St Francis and Niddrie Mill primary schools.

Developer PARC – a joint venture between the council and its arms-length development company EDI – recently announced the

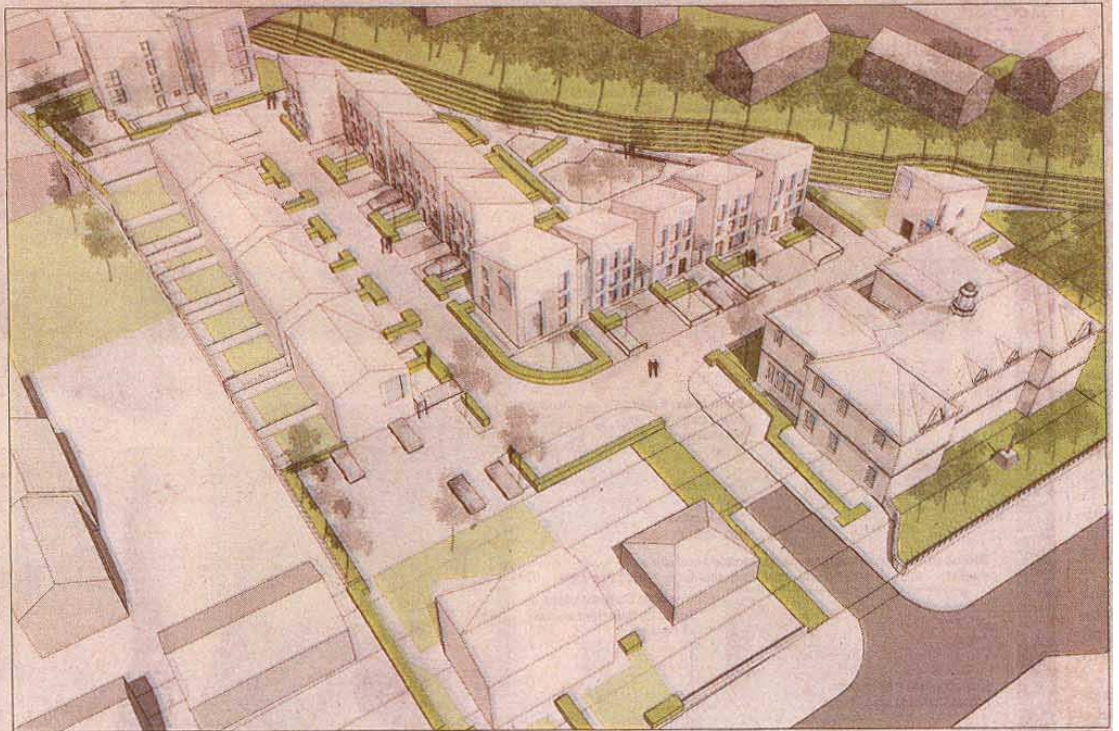

FUTURE: An artist's impression shows the mixture of houses and flats set to be created at the former Niddrie Mill Primary School

scheme is likely to be delayed because of the ongoing financial crisis.

John Quinn, the general manager for PARC, said: “These latest proposals are another step in the regeneration of Craigmillar, and we want to get them through planning so we can be ready to press

ahead with development. It is only right that, given the economic circumstances, we review our work and there is likely to be some delay caused to the programme.

“This is a 15-year plan, however, and it is only to be expected there will be slow times within that period. The opening of the new primary school should be the perfect example of how committed we are to making this work, and the same award-winning architects who designed the school have worked on this part of the project.”

It is hoped the development might stop antisocial behaviour along the Niddrie Burn and help clean up the local wildlife area.

Terry Tweed, secretary of the Craigmillar Community Council, said: “We have put in an objection to the four-storey buildings as we feel they are too high but, in general, the project has the support of local residents.

“The regeneration of Craigmillar cannot come quickly enough.”

gedwards@edinburghnews.com

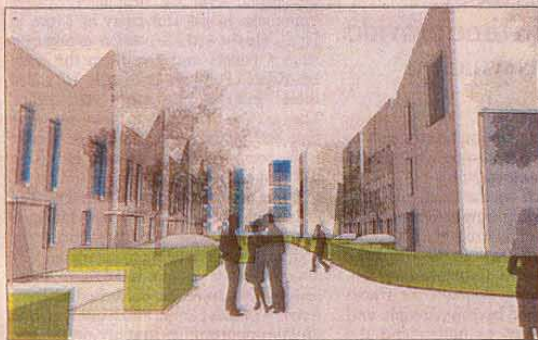

REVAMP: The project is part of the area's £200m regeneration